



## PASSENGER SIDE VACUUM PUMP MOUNTING KIT

P/N: 63916

Note: This kit is designed to mount a Moroso enhanced vacuum pump P/N's 22642/22644/22840 to a Small Block Ford engine on the passenger side only. A Moroso 64885 vacuum pump pulley and a 63917 vacuum pump bracket are required to complete this install. Additionally, a 1/2" x 36" V-belt is the ideal size for this application in conjunction with the 63853 drive mandrel kit.

**IMPORTANT: USE THE FITTINGS SUPPLIED WITH THE VACUUM PUMP. THE USE OF ANY OTHER BRAND OF FITTINGS WILL DAMAGE THE UNIT!**

### Parts List

Item	Description	Qty.
A	3/8-16 x 1.500 SET SCREW	1
B	7/16-14 x 1.500 SET SCREW	1
C	STANDOFF	2
D	WASHER	2
E	3/8-16 x 1.250 SHCS	2

### PASSENGER SIDE INSTALLATION

1. Install the 3/8-16 and 7/16-14 set screws using a 3/16" and 7/32" Allen wrench respectively until they bottom out in the head.
2. Install the standoffs onto the set screws (hex facing the cylinder head) and tighten them using a 3/4" wrench.
3. Connect the 63917 vacuum pump bracket using the provided washers and 3/8-16 SHCS as illustrated below.
4. Mount the vacuum pump from the rear onto the bracket to allow proper clearance for the pulley.

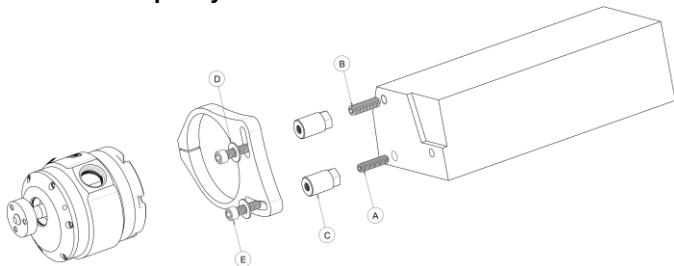

**For Technical Assistance, Call Moroso's Tech Line at  
(203) 458-0542, 458-0546 8:30am – 5:00pm Eastern Time**

MOROSO PERFORMANCE PRODUCTS, INC  
80 CARTER DR • GUILFORD, CT 06437  
Phone: (203) 453-6571 • Fax: (203) 453-6906