



**THROTTLE RETURN SPRING KIT
4500 DOMINATOR & KING DEMON
P/N 64918**

PARTS LIST

- | | |
|------------------------|-------------------------|
| (1) Carburetor Bracket | (1) 1/4-28 x 1.25" Bolt |
| (1) Spring Bracket | (3) Stepped Bushings |
| (2) Springs, 2.5" | (2) Springs, 2.75" |
| (2) Spacers | (2) Thin Spacers |
| (1) 1/4-28 Locknut | |

This Bracket is designed to fit on Holley Dominator and King Demon carburetors.

Mount on the driver side of the carburetor with Spring Mount facing up.

Use appropriate spacers to keep bracket from interfering with linkages.

When placing the Stepped Bushings into the Spring Bracket, make sure they fit together correctly. (see figure A).

Check clearance with air cleaner and throttle linkage. Check wide open throttle for full travel.

Check all bolts and hardware are properly tightened.

Figure A

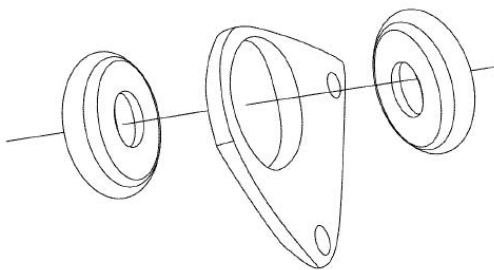

**For Technical Assistance, Call Moroso's Tech Line at
(203) 458-0542, 458-0546 8:30am – 5:00pm Eastern Time**

**MOROSO PERFORMANCE PRODUCTS, INC
80 CARTER DR • GUILFORD, CT 06437
Phone: (203) 453-6571 • Fax: (203) 453-6906**

Visit Us At www.moroso.com